

9. Installing the Radiator Valves

The Radiator Valves easily replace the majority of existing TRVs to give you the ability to schedule each room independently, without any plumbing being required.

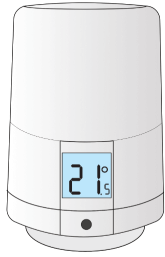

Each Radiator Valve comes with two adapters. The two adapters fit the Radiator Valve onto either an M30x1.5mm thread (the UK standard which fits most brands of TRV) or a Danfoss RA fitting (the adapter with the grub screw). To mount the Radiator Valve:

1. Remove the existing TRV head (this is the part which turns and normally has the number 1-5 on it to regulate the temperature) from the radiator. Usually this requires loosening a nut between the TRV head and the valve body (the part the water flows through). Fasten the new adapter to the TRV body on the radiator. Screw the adapter down onto the TRV body if using the M30 x 1.5mm adapter, or attach the RA adapter & valve onto the radiator & tighten up the grub screw using a 2mm hex (Allen) key. The image below shows the M30 adapter being fitted.

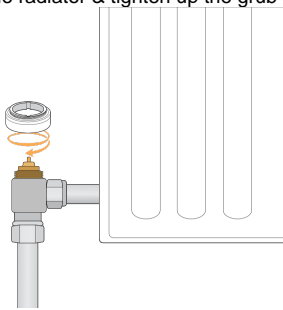

If using the Danfoss RA adapter make sure that the grub screw is done up very tight as the adapters can work loose over time, which stops the Radiator Valve being able to shut off the flow of water to the radiator, causing the radiator to heat up when it is supposed to be off.

2. Remove the battery cover by depressing the tab at the back of the valve, and pull the cover up and away from the valve.



3. Place 2 x AA batteries in the valve, a temperature should appear on the screen.

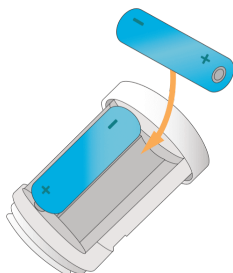

4. Press and hold the button for 3 seconds until an 'M' appears on the screen. The 'M' will begin to flash on the screen, the valve will buzz and the plunger in the underside of the valve will retract. The valve is now in Mount Mode.



The Valve must be in mount mode when being attached to the radiator.

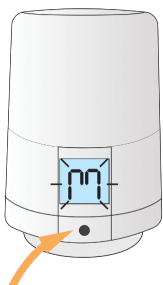

5. Screw the valve down onto the adapter.

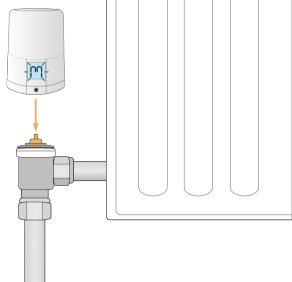

6. Press and hold the button for 3 seconds until the valve starts to buzz and a temperature appears on the screen. This takes the valve out of Mount Mode.



- If you want to get the valve as tight as possible onto the valve body, you need to remove the cover to access the button (which is beneath the button you press from the cover). If you press this button on the valve hard while tightening the valve onto the radiator you will be able to get it tighter, reducing the chances of the valve not being able to control the radiator properly.
- Sometimes when you press a button on the valve it can take 30 seconds for the screen to react. This is normal as the valve may be communicating with the Genius Hub at the time.