

# Adding A New Genius Room Thermostat (HI-WRT-D)

The following explains how to add a new Genius Room Thermostat to a Genius Hub.



If you have an existing Room Thermostat it will need to be factory reset before it is connected to a Genius Hub.

[See here for how to factory reset a Room Thermostat.](#)

First, remove the Room Thermostat from its backplate using a flat bladed screwdriver and placing this in the cutout in the underside of the device, before levering the front away.

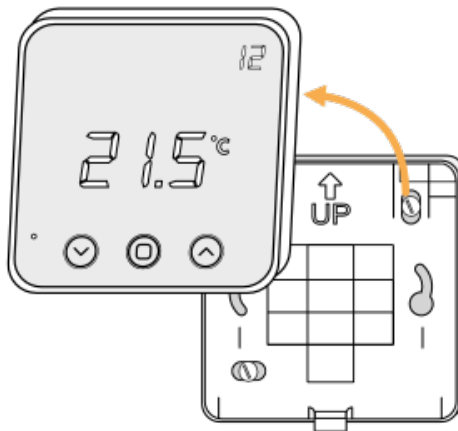

Make sure that the Room Thermostat is within 2 meters (line of sight) of the Genius Hub (the part that is connected to your internet router).

Turn the Room Thermostat over, so the screen is facing away from you and pull out the plastic tab to connect the battery, or insert new batteries.

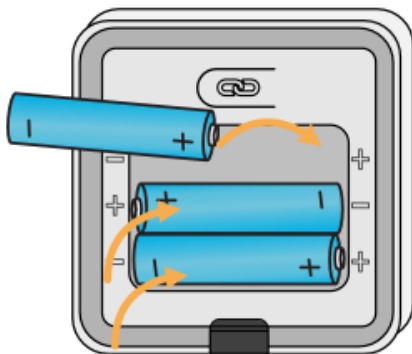

Now the Genius Hub needs to get ready to add the device.

On the app tap on Menu, then Settings and then Devices. Now tap on 'Include device' and follow the prompts on the app.

Ensure the screen of the Room Thermostat is facing away from you.

Press the 'chain' link button above the battery compartment 3 times in quick succession.

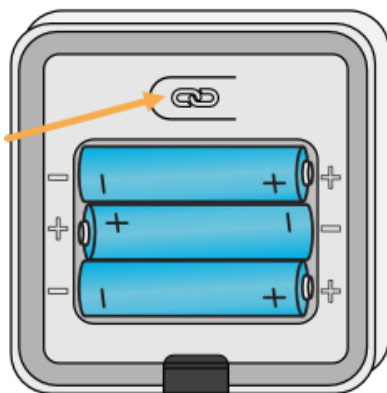

Turn over to read the screen, which should be showing a circling LEDs.



On success, the Room Thermostat will show 'INC' and will have been assigned a number, write this number on the side of the device.

The success or failure of the inclusion will be displayed on the app.

Now pick a zone to assign the Room Thermostat to.

See [Chapter 14](#) of the Manual for full guidance on assigning the channel to a zone. To create a new zone to assign it to see step 5 otherwise skip to step 6.

See the 'Create new zone' section under [Chapter 14](#) of the Manual for guidance on how to create a new zone.

To ensure check the channel has been correctly assigned open the zone's page, tap "Zone Setup" under the menu and check the channel is listed under "Zone Devices".

Attach the Room Thermostat to a wall in the coldest room of the house if controlling the main source of heating, or attach it in the room that you want to control if controlling an individual zone.

First screw the backplate to the wall in the chosen room. Then fit the Room Thermostat onto the backplate by aligning it at the top and rotating it down to meet at the bottom.

Tips for locating the Room Thermostat correctly:

- **At chest height** (so it measures the correct temperature).
- **On an internal wall** (so it measures the correct temperature and is not affected by being on a cold surface).
- **Not next to any direct sources of heat** (so that it measures the temperature of the zone and is not affected immediately by a heat source in the room).

