

# Changing Flat Batteries In The Genius Radiator Valve

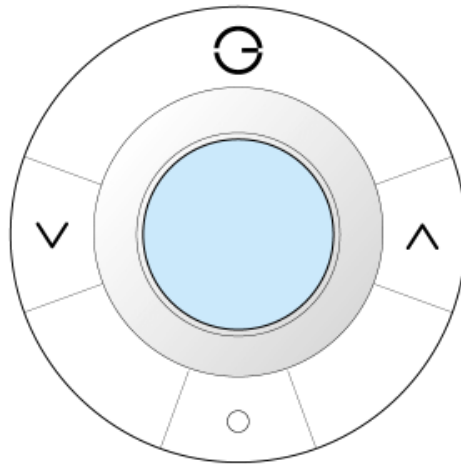

The batteries are flat in the Genius Radiator Valve and the valve will have stopped working altogether.



[Here is a video to show you how to change the batteries](#)

Remove the battery cover. Do this by placing a fingernail at the bottom of the battery cover, pulling the catch up (in the direction of the screen) and compressing the slit next to the catch. The battery cover hinges at the screen end of the valve.

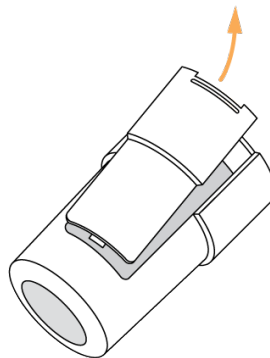

Remove the 2 x AA batteries, (note the orientation of the batteries, one is up and one is down).

Wait 30 seconds before putting in the new batteries.

Rechargeable batteries should not be used as their voltage is too low (1.2v not 1.5v).

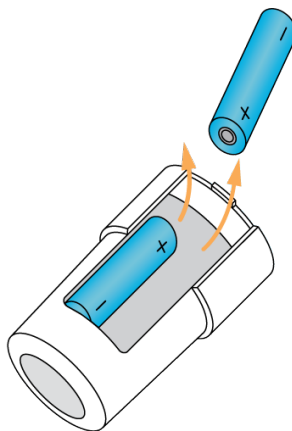

Put in the 2 new AA batteries, take note of the orientation shown on the screen.

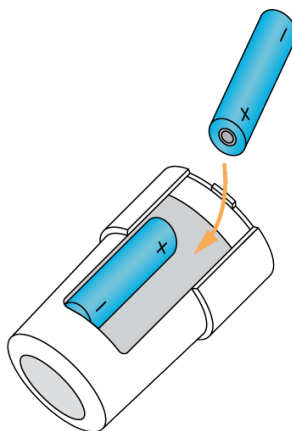

Select the Genius Radiator Valve with the flat battery

The old number for the Genius Radiator Valve may be on the back of the device.

Your system will take around a day to update with your devices values and for any errors to clear.

Wake up the Genius Radiator Valve by short pressing one of the arrow buttons once.

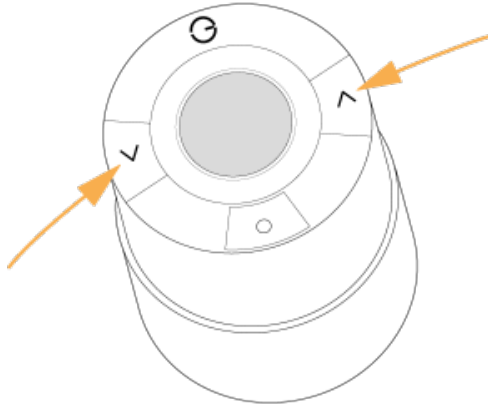

The Genius Hub will check the battery level to ensure that the new battery level has been reported by the device.

Put the battery cover back on, starting at the top.