

Changing Flat Batteries In The Genius Room Sensor

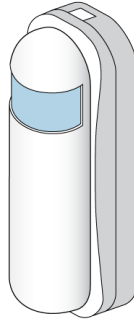

The batteries are flat in the Genius Room Sensor and the sensor will have stopped working altogether.



[Here is a video to show you how to change the batteries](#)

First, remove the front cover of the Genius Room Sensor by placing a tool (such as a flat-bladed screwdriver) into the top of the sensor until you hear a click. This will release the catch.

Use your nails or the screwdriver to pull the white (front) of the room sensor away from the clear (back) and allow the cover to swing down (be careful not to pull the sensor off the wall).

The front is hinged at the bottom.

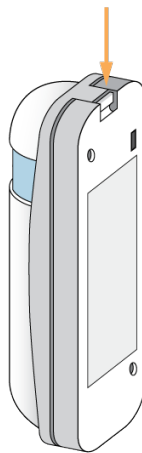

Remove the CR123 battery by pushing it lightly against the spring.

Wait 30 seconds before putting in the new battery.

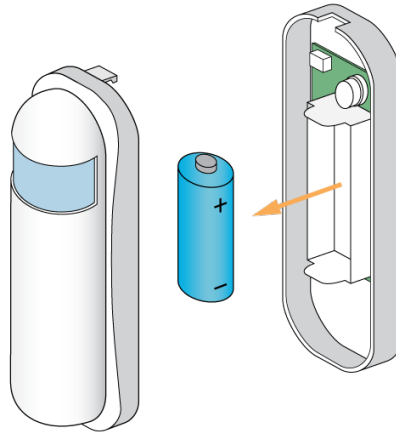

Put in the new CR123 battery.

The light will flash once every second for 30 seconds.

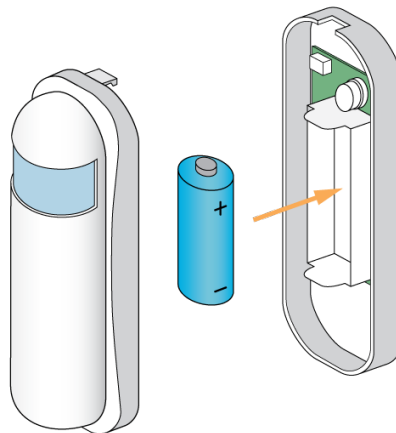

Select the Room Sensor with the flat battery

The old number for the Room Sensor may be on the back of the device.

Your system will take around a day to update with your devices values and for any errors to clear.

Wake the device by pressing the black button at the top left of the device once.

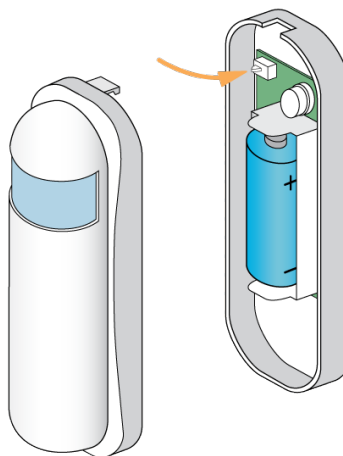

The Genius Hub will check the battery level to ensure that the new battery level has been reported by the device.

To return the cover click it in at the bottom of the device and allow it to hinge up until there is a click as the top locks the cover in place.